

Minami Banana

Full house

House Manual

Available/download online (look for “house manual” under the following page):



<https://minamibanana.com/room/beach-house-villa-ishigaki/>

Emergencies

Typhoons:

Typhoons are part of the regular island life from July to October, with possible outliers year-round. Typhoons trajectory is forecast with high accuracy 1 to 2 days before it hits the island.

In such case, islanders prepare their houses. Our house is no exception and our management company would come to prepare the premises and brief you.

Please strictly follow their indications.

Obviously, don't leave anything outside, stay indoors with windows and doors closed. The gas stove would remain usable in case of power outage.

Hospital:

| | | |
|-------------------------|--------------|--------------------------------------|
| YAEYAMA Hospital | Phone number | 0980-87-5557 |
| | Address | 584-1 Maezato, Ishigaki-shi, Okinawa |

Count 25 minutes' drive to town

Emergency numbers:

| | |
|------------------------------|-----|
| Ambulance, fire | 119 |
| Sea emergency (coast guards) | 118 |
| Police | 110 |

Japan Helpline (0570-000-911; 24 hours) is an all-purpose, English-language information hotline for problems large and small.

Disaster assembly area:

In case of a tsunami alert, you will hear local sirens from the house. Beware some tests are conducted some days (usually at round hours)

The tsunami safe gathering area is indicated on the road:

- Go out to the main road
- Turn left up the hill
- Once up the hill, there is a further turn right indicated that leads you even higher towards the mountain

Minami Banana management:

Please contact Hanashiro san (in Japanese, 日本語) 090 9832-0218 or Benjamin (English etc.) through WhatsApp +852 6012 1025

Check out

Check out time is 10:00 am. Please close doors, windows and leave the keys in the code box as you found them.

Wi-Fi: Minami_2 // welcomebanana

Trash management & garbage sorting

Trash sorting:

Ishigaki has its own rules – please pay attention to the below as it would differ from other Japanese cities.

The city services refuse non-compliant bags. In that case unpicked bags accumulate in the collection box, which may overflow. We then have to reopen the bags, sort items, rinse them, repack new bags, and get them out for collection on the right days to liquidate the accumulated backlog.

Note: for this reason, non-compliant trash bags will be subject to a 2,000 yens charge per bag, charged after check out. This is a rule we are sad to apply, but that has become necessary per experience. Thank you in advance for your understanding.

Please inform all guests in the house to follow the rules strictly and make sure these are followed along the stay.

You'll find in the house manual an additional document in English detailing the sorting rules.

In simplified terms below:

TRASH GUIDE

Trash bags needing opening / rinsing / resorting / repacking / recollecting to be accepted by the city truck will be charge 2,000 yens/bag after check-out

| | What to do ? | Where to dispose ? |
|--|---|--|
| Hard plastics (food trays, hard foam, any plastic that has a hard / molded shape) | Rinse and empty | RECYCLABLE PLASTIC trash |
| Soft plastics (shopping bag, rice bag, wrapping bag, any plastic not molded into a shape) | Empty | BURNABLE trash |
| PET bottles | Rinse and empty Strip the label Unscrew the cap | bottle: PET BOTTLE trash cap: PET BOTTLE trash label: BURNABLE trash |
| Glass bottles (wine bottles, other glass containers) | Rinse and empty Strip the label Unscrew the cap | bottle: GLASS BOTTLE trash label: BURNABLE trash cap: - if metal : CANS trash - if plastic RECYCLABLE PLASTIC trash - otherwise : BURNABLE trash |
| Cans (drink cans, food cans) | Rinse and empty Put the lid inside the can | CANS trash |
| Solid food waste | | BURNABLE trash |
| Cardboard (layered cardboard) (thin cardboard - e.g. beer 6-pack - goes into BURNABLE trash) | Open flat Tie them with rope into a bundle | Dispose of the bundles in the trash collection box on the right day |
| Appliances, toys, lighter, batteries* *there is a separate procedure for button batteries | | UNBURNABLE trash |

In case of doubt, please refer to the official trash sorting document at the end of this manual

Bins location:

The BURNABLE trash, RECYCLABLE PLASTIC trash and UNBURNABLE trash bins are located in each kitchen.

The PET BOTTLES, GLASS BOTTLES and CANS bins are located outside the house.

Downstairs: on the right side of the house when you look at it from the street.

Upstairs: on top of the stairs, just in front of the flat entrance door.

Trash bags:

When replacing a bag in a given bin, please make sure to replace it with the same type of bag (red/blue/transparent). If the trash type and the bag type don't match, trash will not get picked up. There should be enough supply of bags in each kitchen storage. If not, please contact us.

Trash collection:

Trash collection will be managed by our cleaning staff after your check-out.

For full trash bags during your stay, please:

1- tie them up tightly

2- drop the tied bag in one of the big PET BOTTLES / GLASS BOTTLES or CANS bins located:

a) Downstairs: on the right side when you look at the house from the street.

b) Upstairs: on top of the stairs, just in front of the flat entrance door.

These bins are for cans / glass bottles / PET bottles, but it is fine to put the closed trash bags in. The cleaners will deal with them and manage the trash collection.

Trash from the beach:

Trash from the ocean gets washed upon the shore in periods when Northern winds blow.

This trash cannot be sorted through the classic trash collection system. So please don't take it back to the house.

The beach is periodically cleaned and the offshore trash gets treated through a separate system, as it does not correspond to Japanese standards.

Spaces and circulation, outdoor facilities:

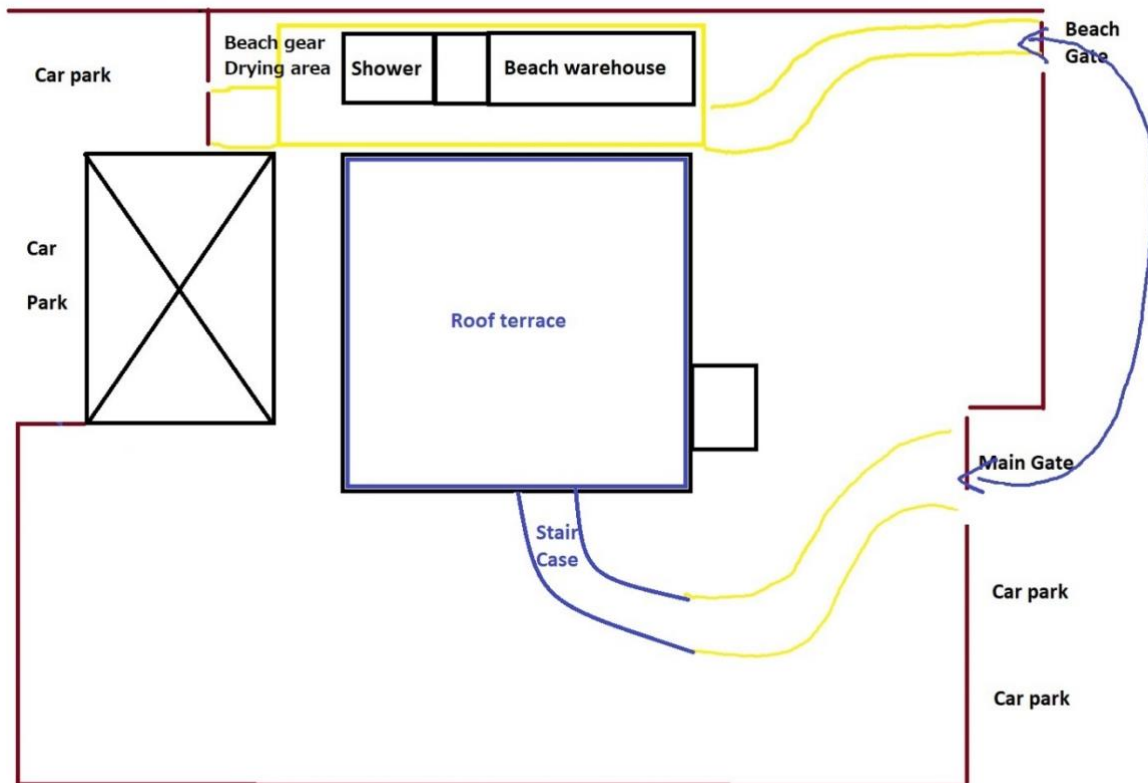

The garage is not accessible.

Going to the beach: foot rinse and showers

When coming back from the beach, you will find a tap to rinse sand off on the badminton court, as well as an outdoor shower.

Entering the house from the bathroom when back from the beach

A good way to keep the house dry and clean is leaving the bathroom door unlocked when going to the beach, so children and adults can enter the house straight from the shower room when back.

It is also your shortest path to a hot shower.

Water/snorkelling gear:

Masks, fins, water shoes, life jackets, inflatables, etc. are available for your use. There is a bungalow ("Beach warehouse") on the right side of the house when you look at the house from the gate (no confusion with the garage at the back).

All that is in there is for your use. Please take the sand off, rinse with fresh water and dry before putting back after use. There are 2 big waterproof backpacks (orange and grey) as well which are handy to transport gear to/from the beach.

Next to the bungalow is an outdoor shower for your use as well.

In case you need more water gear (wetsuits, protective clothing, etc.), our neighbour Jellyfish rents/sells some.

Barbecue:

Feel free to enjoy barbecue at the dedicated Braai area at the back of the house. The barbecue gear is stored in the beach warehouse.

There is another barbecue on the roof terrace. The barbecue gear for that one is stored inside the roof storage. Please store it back in there only after it cools down.

Please dispose of ashes once cool (BURNABLE trash), and clean the grid enough so there are no solid residue and the next guest can use. **Failing to do so would incur an additional cleaning charge** after checkout.

The barbecue cleaning is not included in the general cleaning fee, to be fair with people not using it. Thank you for your understanding.

A small table top gas barbecue (outdoor use only) is available and stored in the beach warehouse. For grilling slices, yakiniku style.

Lanterns:

You may use our outdoor lanterns (some electric ones and a candle lantern) for outdoor dining. Please make sure to bring back the lanterns to their respective floors after use.

Indoor facilities (Garden unit):

Laundry:

The washing machine is located outside the bath cabin, opening the door to the outside.

You can hang things outside, on the big set of hanging bars next to the outdoor shower. These are used as well for drying beach gear.

Alternatively, you may use the hanging bars on top of the bathtub and the dehumidifier which is kept behind the bathroom door (between the bathroom and the kitchen).

You can close the door of the bath cabin with the dehumidifier plugged.



There is a clothespin set and a hanger set on the shelf next to the washing machine or in the bathroom drawers.

Drinking water

Tap water is drinking water in Ishigaki.

Hot water

The hot water command for downstairs is in the bathroom above the towel bar.

Indoor facilities (Rooftop unit):

Laundry:

You can hang things outside if sunny (hanging bars on the side balcony just out of the shower room). Alternatively, you may use the hanging bars on top of the bathtub and the dehumidifier which is next to the washing machine. You can close the door of the bath cabin with the dehumidifier plugged.



There is a clothespin set and a hanger set in the cupboard under the sink in the shower bathroom.

Drinking water

Tap water is drinking water in Ishigaki.

Hot water

The hot water command is next to the entrance door of the bigger bedroom.

Extendable table

The living room table can be extended in order to seat 8 people (see pic below, pull the lower part of the table from the side where you can feel a hook in the middle (red circle))

The bar stools can be lowered in order to make 8 seats for the extended table.



House Rules – Dos & Don'ts

No smoking – Penalties apply, the greater of 30,000 JPY and the actual damages.

No shoes inside the house. Note: the entrance wooden deck downstairs is already a no-shoes area.

No sand and no water inside the house.

Please close all doors and windows when going out at any time.

No grilling inside (yakniku, BBQ, and others)

No pets

From May 1st to August 31st, flying termites are hitting the island on some nights.

Please do not open windows after sunset, even with the insect net screens on. Termites entering the house may settle and cause great damage.

Thank you for your help in keeping the house healthy.

No loud noise, especially after 22:00, as respect to the neighbours.

Please request authorisation with us before welcoming anyone to the premises.

The blue paint on the bar in the garden unit is weak and can stain clothes. Please be careful. We will change it for the next season at Minami Banana.

The best way to clean the bar with no marks is to use glass-cleaning product.

Please watch for no swinging on the roof terrace hammock. It can be dangerous with a risk of deadly fall beyond the rooftop fence.

Enjoying Yonehara Beach

Yonehara beach and lagoon are natural parks. Fishing is forbidden as well as touching corals or collecting marine organisms. Full rules below:



https://www.env.go.jp/park/iriomote/E_yonehararuru_t.pdf

Access:

The beach is right behind the trees on the left when getting out of the garden. Access is open 24/7. At times the car gate (campground gate) may be closed, but you can still access by walking on the side of it.

Tides:

There is not enough water to swim at low tide sometimes (think 30% of the day), hence it is important to check the tide and levels when planning the day.

Please don't walk on the coral rocks. Even on areas where most corals are dead. Touching corals makes them die or prevent them from growing again. It has actually grown in recent years in the area. But not on areas where people walk.

You can find tidal data through the link below:



<https://www.tideschart.com/Japan/Okinawa/Ishigaki—shi/Isigaki/>

Using this chart, you would need at least 0.8m height to swim, 1.0m height to do water sports (SUP, etc.)

Snorkelling:

Yonehara reef is one of the top snorkelling and diving spots on the island.

Within short reach, the nicer coral area is situated to the far left of the beach. (left side when you look towards the water from the house)

The best underwater scenery happens on the reef edge. For good swimmers only with appropriate caution, and only when the sea is flat. It is a 200m swim from the shore, straight in front of the house. Corals are most beautiful there, and you can easily spot sea turtles swimming 10~20m outside the reef edge, when going 100m~200m to the left. (left side when you look towards the water from the

house). When going to the reef edge, please make sure of the tide so the water is high enough to swim back. Don't walk on the reef. It destroys what we came to enjoy – and may hurt.

Sea turtles come for feeding very early mornings (the first hour or 2 after sunrise) in the shallows, to the right side of the lagoon.

From May to August, you may be lucky to spot turtle tracks on the sand in early mornings as they come lay eggs. They hatch 90 days later (August to November)

You may spot the fishes and identify them later on the wall poster or on the picture book kept on the shelves.

For information on the beach, the reef, the Blue Cave, the National Park, Hanashiro san at the Jellyfish neighbour shop are the top specialists. They know literally all spots and resident fish on the reef (e.g. all clown fish anemones). They also monitor and protect the turtle nests, the hatching of eggs. They are the best guides for reef swims, turtle swims, Blue Cave visits, etc.

Currents:

Lagoons fill and empty with tides and waves, generating currents that can take you out to sea. Please stay aware of currents at all times and apply appropriate caution and supervision. In case you get caught in a current:

- a- Don't panic
- b- Swim perpendicularly to the current till you get out of it

Sea snakes, jellyfish

Sea snakes (black and white banded sea kraits) are common in the lagoon. While their venom is highly toxic, they are very peaceful and their mouth is very small. They could bite humans between fingers, or ear lobes. While fishes tend to move away from swimmers, sea snakes usually keep their direction, undisturbed. Keep your eyes open, don't play with them and enjoy the scenery.

Jellyfish stings are serious. While not common, blue bottle and box jelly fish have been reported on the island. Better seek medical help without waiting in case of a sting.

Shared online map / Local tips

Restaurants, shops, sightseeing and activities. Details in the coming pages.

All tips are earmarked on the shared map accessible from our online guide page. Please follow the link below and click on “Minami Banana interactive map”.

You may bookmark the link in your mobile to access while out and about.



<https://minamibanana.com/ishigaki-yonehara-guide/>

Groceries / convenience store

In the area:

There is only one meaningful place without going to town, which is Karimata shoten in Yoshihara (see map). It is open every day, no exception from 14:00 to 21:00.

Karimata san has convenience store basics, and some fresh products from local farmers. Fresh eggs, vegetables and fruits of the day. Sashimi occasionally. Better go early for better supply.

You will find as well roadside booths from locals where you can buy local produce and drop coins in a box.

In town:

Going to town, we recommend the Yurateiku farmers' market. A permanent grocery shop filled with local produce.

For supermarkets, Max Valu (Open 24 hours) and Kanehide are the generic options, San-A a bit more upmarket.

For great Ishigaki meat, Misaki-gyu on the outskirts of town is the place to go. Best quality and affordable when buying at their shop – where you can eat yakiniku on the spot. Other shops pride on serving Misaki-gyu as their top meat, and may charge you double price.

Taxis / Driver service / Daiko

Our address:

Some drivers may know “Minami Banana”

For others, our address is Fukai 644-40. Next to Yonehara Kominkan (our neighbour towards the main road). Some would know Hanashiro-ya or Jellyfish (our neighbours towards the beach) as landmarks.

Taxi:

Heianzan san (individual driver): 090 5947-8731

Taxi company: 0980 88-1777

Daiko:

Daiko services is basically people who will come wherever you are and take you AND your car to wherever you want to go. Like a taxi with a spare driver to drive your car.

They are surprisingly affordable.

Alcohol tolerance for driving is ZERO in Japan. Even one drink will push you over the legal limit. Controls are frequent.

So, if you had a drink and cannot drive back, please use this service. If you don't speak Japanese, the restaurant owner will always make a point to assist.

石垣島 南星運転代行

090-1366-7964

Restaurants

There are a lot of lunch options around. For dinner, you would need to drive to Kabira (10 minutes). As a closer option, Café Stella is open for dinner on Fridays and Saturdays and can accommodate if you book on other days ! Café Moment at the back of the house is happy to open for dinner upon request.

Please refer to the shared map (QR code and link in an earlier paragraph) for locations.

Possible breakfast/dinner arrangements with our neighbour:

Japanese breakfast or dinner can be provided with our neighbouring ryokan – at times when they are not full. You would need to notify Hanashiro-ya by noon for same-day dinner or next-day breakfast. Please contact us in case of interest.

Walking distance:

Café Moment

Just behind the house. Outdoor seating for lunch and coffee. Café Moment is happy to stay open for dinner and drinks upon request.

Tonkatsu Riki

Close by on the main road. A long-time local favourite. Be prepared to queue.

Jellyfish

Our neighbour on the way to the beach. Open in high seasons. Serves taco rice, yaeyama soba on outdoor seating. As well as ice cream and kakigori.

Chibana shokudo

Just up the hill from the house. Great local setting. Yaeyama soba is the only dish. They are open for lunch all days except Fridays and Saturdays.

Kitchen Yonehara Shokudo

Close by. Open during the season.

A short drive away:

You will find a concentration of cafes and lunch restaurants in Yamabare (5min drive to the west, stretch of houses after the red bridge)

Cafe Stella

The best cook in the area. Open every day for lunch except Wednesdays and Thursdays. Dinner on Friday and Saturday nights, and upon booking request. It is located in Yoshihara, the next hill after Yamabare.

Kato Soba

A local favourite. Very nice setting with a view. Very tasty soba, but above market prices.

Café Laguna

Usually open till 18:00. Convenient for late lunch.

In Kabira (most are open for dinner)

Hama

One-man show. The best cook in Kabira although the setting is basic. Open for dinner till very late.

Jinbei

For sushi and seafood. Open for dinner.

Le Dodo

Le Dodo serves authentic Mauritian foods. Spice curry, raw fish fruity carpaccio. The owner is very welcoming, Mauritian himself and a former cook from nearby Clubmed.

Yui

Mostly a bar, with the widest Awamori menu. Great food options. Open for dinner, staying open late.

Kabira-Tei

Good food in a nice setting. Open for dinner.

Umaru

Nice old wooden house. Okonomiyaki and other dishes. Open for dinner.

Koen Chaya

Inside Kabira park, nice place under the trees. Local soba. Lunch only.

Gohan-ya

Nice bento and very nice people, in front of Jinbei.

Garden Panna

One of our favourite spots. Nice garden with a view, very tasty dishes and teas. Original creations using the garden herbs. Lunch only.

Ishigaki shoten

Good Vietnamese, Thai and local food. Lunch only.

In town:

Misaki gyu

Ishigaki beef yakiniku and butchery. The best yakiniku shops in town pride themselves on serving meat from Misaki gyu... Which you can have for much cheaper directly at Misaki gyu !

Ishigaki ya

Yakiniku. Great Ishigaki beef. Nice setting. 4000-5000 JPY per head.

Funakura no Sato

Izakaya. Nice complex old wooden houses and garden. Better book in the "kissaten" room for a much nicer setting than the bigger hall. Some chilled shamisen animation at dinner time. Count 3kJPY/head. Great for lunch too.

Shiishii Gangan

Small izakaya. Very good and affordable food in a modest setting. Ooshima san made his career as a chef at the Intercontinental. Trust him with an omakase set !

Maruha sashimi shop

Sashimi shop with a terrace on the port. Can eat on the spot - they have rice and tempura as well. Open daytime. Great snack when coming back from outlying islands (short walk from the boat).

Kokkara

Kaiseki. Great food in a very private setting within the host's house. Dinner only, booking only. 4~8k JPY/head. Hard to find in the fields. You'll need navigation, and better to go before sunset !

Juices, ice-creams, bread, pastries...

Papaya juice shop

Up the hill from home on the east side, next to the entrance to the Yaeyama palm grove. Possibly the best juices on the island (not just papaya !). Using sugar cane juice instead of sugar.

Jellyfish

Our neighbour on the way to the beach. Serves ice cream and kakigori during the season.

Pinacolada

Great bakery in Kabira. On par with the best bakeries in Tokyo or in France. Great breads and pastries with original local creations. Open from 9:30 to 15:00. Go early for more choice. Closed Mondays and Tuesdays.

Jellyfish

Our neighbour on the way to the beach. Serves ice cream and kakigori during the season.

Mirumiru

Local Ishigaki ice creams. Our favourite ones on the island. You will find them in a few places (e.g. at the domestic terminal of the airport), but the best spot is their headquarters in the fields on top of a hill in Fusaki, with a sea view facing Taketomi island. Great on a late afternoon before sunset.

Sightseeing and activities

Please refer to the shared map (QR code and link in an earlier paragraph) for locations.

Close to the house:

Yonehara beach

(see the specific section about it !)

Arakawa waterfall

On the main road to the west. 20min walk / 4min drive.

Great swimmable waterfall with easy access and a swinging Tarzan rope. Amazing to refresh on a hot day. Very beautiful as well. Park on the 3-vehicle car park and go down to the falls by the staircase on the west side of the little bridge.

Blue cave

The seawater cave is accessible from the sea. Nice snorkelling around. Best accessed through a tour with our neighbour Jellyfish.

Crystal beach

The access to the beach is tricky to find (refer to my map). Beware of the steep path down. Go with appropriate shoes (avoid beach sandals). The beach is very scenic and a deep stretch of sand. You can find crystals in the sand brought from the river. Snorkelling is very good and the reef edge is close. Often strong currents as the lagoon opens right in front. STAY AWARE !

Yaeyama Palm grove

Nice outing to go see the endemic Yaeyama palm trees (spot them on the mountain from the house !). And a good occasion to grab a juice at Papaya.

Shiisa park Yoneko Yaki

Park with giant statue / totem creations following the local Shiisa theme. Actually a pleasant park with original creations. Fun for children as well. You can't miss it from the road. 2-minutes walk !

Fukido gawa mangrove

You can go down from the bridge and venture for a few 100 meters in the sand. Spot mudskippers and colonies of colourful violinist crabs.

Mape – Nosoko dake (Nosoko peak summit)

You can spot the summit from Yonehara beach, the pointy mountain to the north-east.

Easy 20min hike with stunning 360-degree view from the rocky top. Highly recommended.

Kabira Bay

THE landmark view of the island and a view rated 3-star by Michelin. Don't miss the walk and the viewpoints in Kabira park. The walk along the sand northwards to the next beaches is very nice too, and less crowded.

The glass-bottom boat tour is cheap and surprisingly good, going over the reef of the natural park. A success with children and definitely nice to see if you haven't done any snorkelling around.

Beaches:

See the map !

Everyone has his own favourites and there are a lot on the island. Some with easy reference and access. Some more secret with sometimes difficult access.

The best beaches are:

- The Kabira coast, where we are, stretching from Sakieda to Nosoko.
Yonehara beach and Crystal beach (see above)
Sakieda beach is renowned for snorkelling.
Sukuji beach is sandy, with shade, an easy one with children (high tide only)
The beaches north of Kabira (between Kabira village and club med) are swimmable even at lower tide.
Nosoko has a rocky coastline with many secluded coves. And some west-facing stretches of sand for sunset

- The northern peninsula with some long stretches (Akaishi beach), anything north of Akaishi beach on the east-side dirt road till Hirakubo light house.
Ibaruma beach with lots of rocks sticking out of the water.
Sunset beach for... sunset.

- Close to town
Fusaki beach is nice for sunset (free access through the hotel) and enjoying the hotel facilities on a day pass. Banana boat, etc.

Beaches on the South side, and East side, up to the airport are not inviting. (flat and rocky, or no beach). Nagura wan is very nice to drive-by but not really swimmable

Snorkelling:

Apart from the beaches (above), the Shiraho reef has some very nice coral and underwater life. I went there with a guide on a small boat that I can recommend (difficult to find the best spots on your own).

Shinzato san 090 6863 1717

For snorkelling tours at Yonehara or at the Blue Cave, you may see directly with our neighbour Jellyfish
Tel: 0980 87-7838 / 090 4510 0117
Email: jellyfish644@gmail.com

For boat snorkelling tours in the Nosoko area, Matsumura san is your best option
Tel: 0980 89-2939 / 090 1944-4740
www.fruit-ishigakijima.com

For boat snorkelling tours in the Kabira area, including to see manta rays, we can recommend Euro-divers (see the Diving section below).

Diving:

There is gorgeous diving in Ishigaki. From manta rays spotting, turtles, squids, coral reefs, caves, and a very rich marine life around.

There are a lot of Japanese-speaking-only diving centres – which I haven't tested.

There are only very few centres speaking foreign languages (they also speak Japanese). Euro-divers is a great choice and my go-to shop. Highly experienced professionals, based right in front of the manta spot at Club Med. Pickup from the house is possible. See leaflet at the end of the house manual

<https://www.euro-divers.com/scuba-diving-ishigaki-kabira-japan/>

SUP tours (mangroves, coastline):

SUP is a great way to discover rocky coastlines, inaccessible beaches, and go deep in the mangroves.

There are a lot of tour companies (no-one will just rent).

Remote island hopping:

The remote island terminal in town is the gate to the Yaeyama.

A day-trip to one of the islands is a MUST DO for any stay. You will rent a bicycle and go around, visit the traditional village and sample the beaches and island curiosities.

Taketomi island: The most popular. Very picturesque village. Nice shallow sand banks, not great snorkelling. The closest island (10min) with the best boats frequency, and the crowdiest.

Kuroshima: A good alternative. More rural, with lots of cattle. Nice snorkelling. Small traditional village, less picturesque than Taketomi. The local museum with little sharks swimming in puddles is worth the visit.

Hateruma island: More remote. Picturesque beach and good snorkelling at Nishihama. Laidback village. The boat trip is significantly longer (1.5 hours) but still ok on a day trip.

Iriomote island: Bigger than Ishigaki and very wild. Most of the island is a jungle reserve. The trip up the river through the mangrove combined with a hike to the waterfall is the classic one. Very nice beaches too and worth a stay.

Hiking:

Ishigaki boasts the highest mountain in Okinawa, Omoto san, which overlooks the house.

Hiking in the jungle is rewarding with beautiful flora, fauna, and waterfalls.

There are frustrations though to get views from mountain tops as thick vegetations (and high bamboos from about 300m altitude) are blocking the sight. For views, you'll need boulders sticking out of the jungle and rocky tops (like Mape / Nosoko Dake summit). We don't recommend the hike to the top of Omoto san for that reason.

You will find a few hiking paths marked and referenced – Mape / Nosoko dake is one.

Star gazing:

The rooftop and the beach are great spots on a clear night. For more, you can try the astronomical observatory, on a mountaintop close to town. They have some open nights and shows.

<http://www.miz.nao.ac.jp/ishigaki/>

Mangroves:

The Nagura mangrove (bigger and nicer) and Fukido gawa mangrove (closer) are great natural landscape to discover. For a short walk on the sand down the bridge, or for a SUP tour (see above).

Scenic drives:

Nagura bay: on your trip to town, you should at least once skip the tunnel and go the west way, using the road along the west coast. Best in late afternoon.

Sakieda peninsula, Hirakubo peninsula are classic scenic drives, with the lighthouses being nice objectives.

Some great views while driving at the tip of the Kabira peninsula along the coast through the Club Med premises (allowed). Some nice rocks to climb up for views and nice (barely accessible) beaches

Yaima village:

Good for children to get introduced to the local culture through simple workshops. Some cute monkeys as well.

Pottery classes :

On rainy days, tried your hand at making Shiisa with all the family. Phone to book and make sure.

Rinka: 7 min drive, charming spot in Yoshihara www.rinka-ishigaki.jp

Kaeruya: in town. Highly rated classes. Phone: 090-5304-1013, Address: 15-1 Okawa, Ishigaki Shi

Atelier Repos: in town. Phone: 080-4313-0043, Address: 14-1 Ishigaki, Ishigaki Shi

Glass blowing classes:

If you get a second rainy day. <https://ponte-glass.com/>

Phone: 0980 82-4620, Address: 1625-35 Arakawa, Ishigaki Shi

Limestone caves:

One in town and one in Ibaruma in the north (same distance)

Nice limestone cave. Similar to any limestone stalactite cave anywhere else in the world but always exciting for children.

Banna Park Adventure playground:

Banna Park features a public, free children space with very impressive slides, it is always a great success with children. You may want to bring a piece of cardboard in order to facilitate sliding and protect clothes on some of the slides. It is a 22minutes drive away (see map), nestled in the mountain.