

Minami Banana

Rooftop flat

House Manual

Download online (look for “manual” on the following page, just above the photo gallery) :



<https://minamibanana.com/room/rooftop-apartment/>

Emergencies

Typhoons:

Typhoons are part of the regular island life from July to October, with possible outliers year-round. Typhoons trajectory is forecast with high accuracy 1 to 2 days before it hits the island.

In such case, islanders prepare their houses. Our house is no exception and our management company would come to prepare the premises and brief you.

Please strictly follow their indications.

Obviously, don't leave anything outside, stay indoors with windows and doors closed. The accessory gas stove would remain usable in case of power outage.

Hospital:

YAEYAMA Hospital	Phone number	0980-87-5557
	Address	584-1 Maezato, Ishigaki-shi, Okinawa

Count 25 minutes' drive to town

Emergency numbers:

Ambulance, fire	119
Sea emergency (coast guards)	118
Police	110

Japan Helpline (0570-000-911; 24 hours) is an all-purpose, English-language information hotline for problems large and small.

Disaster assembly area:

In case of a tsunami alert, you will hear local sirens from the house. Beware some tests are conducted some days (usually at round hours)

The tsunami safe gathering area is indicated on the road:

- Go out to the main road
- Turn left up the hill
- Once up the hill, there is a further turn right indicated that leads you even higher towards the mountain

Minami Banana management:

Please contact Hanashiro san (in Japanese, 日本語) 090 9832-0218 or Benjamin (English etc.) through WhatsApp +852 6012 1025

Check out

Check out time is 10:00 am. Please close doors, windows and leave the keys in the code box as you found them.

Wi-Fi: Minami_2 // welcomebanana

Trash management & garbage sorting

Trash sorting:

Ishigaki has its own rules – please pay attention to the below as it would differ from other Japanese cities

The city services refuse non-compliant bags. In that case unpicked bags accumulate in the collection box, which may overflow. We then have to reopen the bags, sort items, rinse them, repack new bags, and get them out for collection on the right days to liquidate the accumulated backlog.

Note: for this reason, non-compliant trash bags will be subject to a 2,000 yens charge per bag, charged after check out. This is a rule we are sad to apply, but that has become necessary per experience. Thank you in advance for your understanding.

Please inform all guests in the house to follow the rules strictly and make sure these are followed along the stay.

You'll find in the house manual an additional document in English detailing the sorting rules.

In simplified terms below:

TRASH GUIDE

Trash bags needing opening / rinsing / resorting / repacking / recollecting to be accepted by the city truck will be charged 2,000 yens/bag after check-out

	What to do ?	Where to dispose ?
Hard plastics (food trays, hard foam, any plastic that has a hard / molded shape)	Rinse and empty	RECYCLABLE PLASTIC trash
Soft plastics (shopping bag, rice bag, wrapping bag, any plastic not molded into a shape)	Empty	BURNABLE trash
PET bottles	Rinse and empty Strip the label Unscrew the cap	bottle: PET BOTTLE trash cap: PET BOTTLE trash label: BURNABLE trash
Glass bottles (wine bottles, other glass containers)	Rinse and empty Strip the label Unscrew the cap	bottle: GLASS BOTTLE trash label: BURNABLE trash cap: - if metal : CANS trash - if plastic RECYCLABLE PLASTIC trash - otherwise : BURNABLE trash
Cans (drink cans, food cans)	Rinse and empty Put the lid inside the can	CANS trash
Solid food waste		BURNABLE trash
Cardboard (layered cardboard) (thin cardboard - e.g. beer 6-pack - goes into BURNABLE trash)	Open flat Tie them with rope into a bundle	Leave next to the trash boxes indoors, the cleaning staff will manage after check out
Appliances, toys, lighter, batteries* *there is a separate procedure for button batteries		UNBURNABLE trash

In case of doubt, please refer to the official trash sorting document at the end of this manual

Bins location:

The BURNABLE trash, RECYCLABLE PLASTIC trash and UNBURNABLE trash bins are located in the kitchen.

The PET BOTTLES, GLASS BOTTLES and CANS bins are located outside the entrance door to the right.

Trash bags:

When replacing a bag in a given bin, please make sure to replace it with the same type of bag (red/blue/transparent). If the trash type and the bag type don't match, trash will not get picked up. There should be enough supply of bags in the kitchen closets. If not, please contact us.

Trash collection:

Trash collection will be managed by our cleaning staff after your check-out.

For full trash bags during your stay, please:

- 1- tie them up tightly
- 2- drop the tied bag in one of the big PET BOTTLES / GLASS BOTTLES or CANS bins located outside the entrance door to the right.

These bins are for cans / glass bottles / PET bottles, but it is fine to put the closed trash bags in. The cleaners will deal with them and manage the trash collection.

Trash from the beach:

Trash from the ocean gets washed upon the shore in periods when Northern winds blow.

This trash can only be collected through a separate collection system, as it does not follow the Japanese recycling standards. You can collect pink bags from Jellyfish, the rental shop between the house and the beach and leave the full bags in the dedicated box.

Please don't take beach trash back to the house.

Spaces and circulation, outdoor facilities:

Shared spaces:

The Rooftop flat enjoys exclusive use of the roof terrace.

The Garden flat enjoys exclusive use of the garden and badminton court

Beach facilities are shared. They comprise the water gear, the outdoor shower, and access through the Beach Gate.

There are 2 parking spots in the front, and 2 at the back.

Rooftop flat: can use one spot at the front and one spot at the back

Garden flat: can use one spot at the front and one spot at the back

The Garden flat has big windows all around. In order to safeguard privacy, guests from the Rooftop flat will use the main gate and go around the property in order to access the beach facilities and the trash collection bin. Thank you for your cooperation.

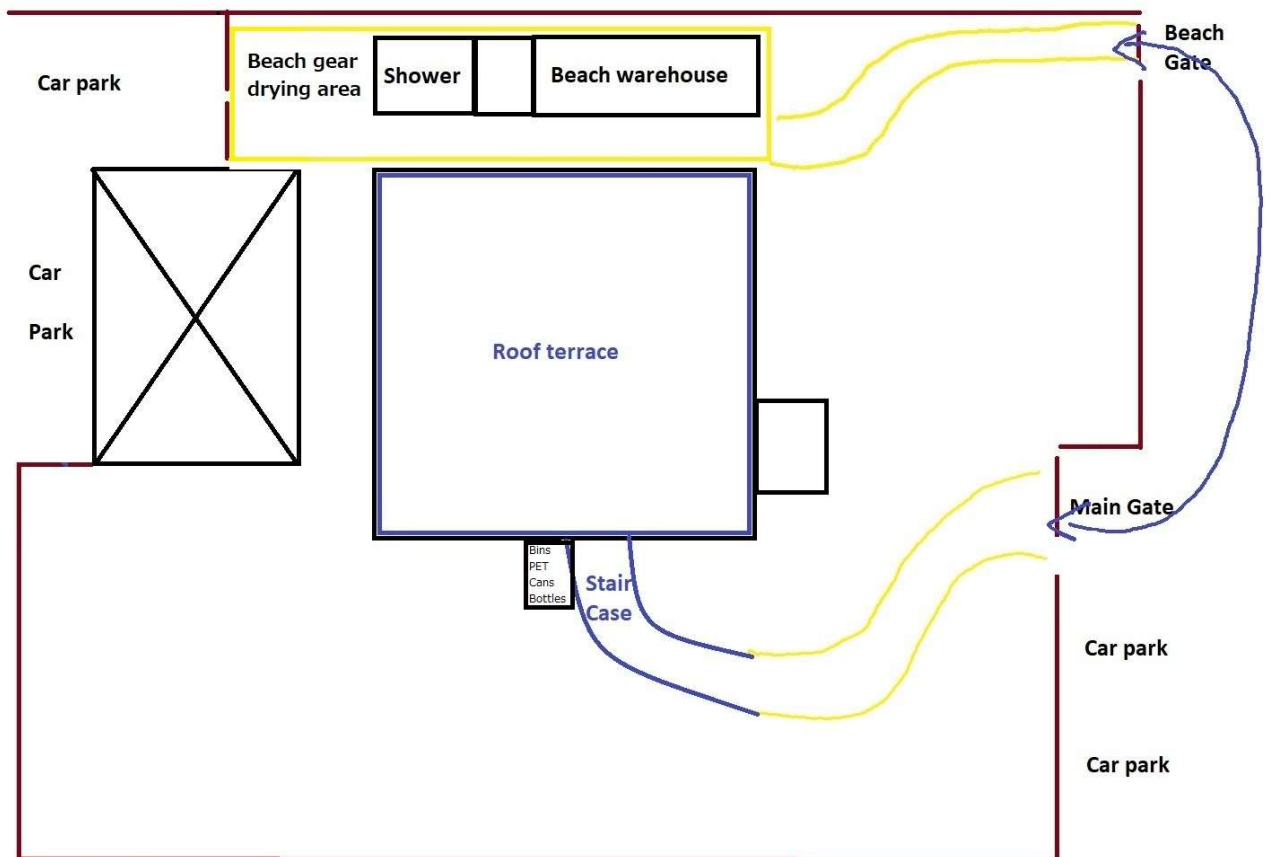

In blue : Areas exclusive to the Rooftop flat

Blue arrows : Path to access the beach facilities and the trash collection bin

In yellow : Shared areas

The garage is not accessible.

Going to the beach: foot rinse and showers

You may use the Beach Gate to go pick-up water gear before going. When coming back, you will find a tap to rinse sand off on the badminton court, as well as an outdoor shower.

Entering the house from the bathroom when back from the beach

A smart fun way to keep the house dry and clean is leaving the bathroom door unlocked, so children can go around the balcony and go in the house straight into the shower room. The balcony is unfortunately too narrow for most adults to go around without bending gymnastics.

Water/snorkelling gear:

Masks, fins, shoes, life jackets, inflatables, etc. are available for your use. There is a bungalow ("Beach warehouse") on the right side of the house when you look at the house from the gate (no confusion with the garage at the back).

All that is in there is for your use, and shared with the Garden flat. Please take the sand off, rinse with fresh water and dry before putting back after use. There are 2 big waterproof backpacks (orange and grey) as well which are handy to transport gear to/from the beach.

Next to the bungalow is an outdoor shower for your use as well.

In case you need more water gear (wetsuits, protective clothing, etc.), our neighbour Jellyfish rents/sells some.

Roof terrace:

The roof terrace is for your exclusive enjoyment.

The barbecue, extra table and chairs are in the rooftop storage.

Barbecue:

Feel free to enjoy barbecue on the roof terrace. The barbecue gear is stored inside the roof storage. Please store it back in there after it cools down.

Please dispose of ashes once cool (BURNABLE trash), and clean the grid enough so there are no solid residue and the next guest can use. **Failing to do so would incur an additional cleaning charge** after checkout.

The barbecue cleaning is not included in the general cleaning fee, to be fair with people not using it. Thank you for your understanding.

A small table top gas barbecue (outdoor use only) is available in the little room next to the outdoor shower. It is shared with the Garden flat. For grilling slices, yakiniku style.

Lanterns:

There are electric lanterns and a candle lantern in the entrance cupboard. Please make sure to place them back in the cupboard after use.

Handy to enjoy starry roof nights.

Indoor facilities:

Laundry:

You can hang things outside if sunny (hanging bars on the side balcony just out of the shower room). Alternatively, you may use the hanging bars on top of the bathtub and the dehumidifier which is next to the washing machine. You can close the door of the bath cabin with the dehumidifier plugged.



There is a clothespin set and a hanger set in the cupboard under the sink in the shower bathroom.

Drinking water

Tap water is drinking water in Ishigaki.

Hot water

The hot water command is next to the entrance door of the bigger bedroom.

Extendable table

The living room table can be extended in order to seat 8 people (see pic below, pull the lower part of the table from the side where you can feel a hook in the middle (red circle))

The bar stools can be lowered in order to make 8 seats for the extended table.



House Rules – Dos & Don'ts

No smoking – Penalties apply, the greater of 30,000 JPY and the actual damages

No shoes inside the house

No sand and no water inside the house.

Please close all doors and windows when going out at any time.

No grilling inside (yakniku, BBQ, and others)

No pets

From May 1st to August 31st, flying termites are hitting the island on some nights.

Please do not open windows after sunset, even with the insect net screens on. Termites entering the house may settle and cause great damage.

Thank you for your help in keeping the house healthy.

No loud noise, especially after 22:00, as respect to the neighbours.

Please request authorisation with us before welcoming anyone to the premises.

Please watch for no swinging on the roof terrace hammock. It can be dangerous with a risk of deadly fall beyond the rooftop fence.